

BACKHOE COUPLER

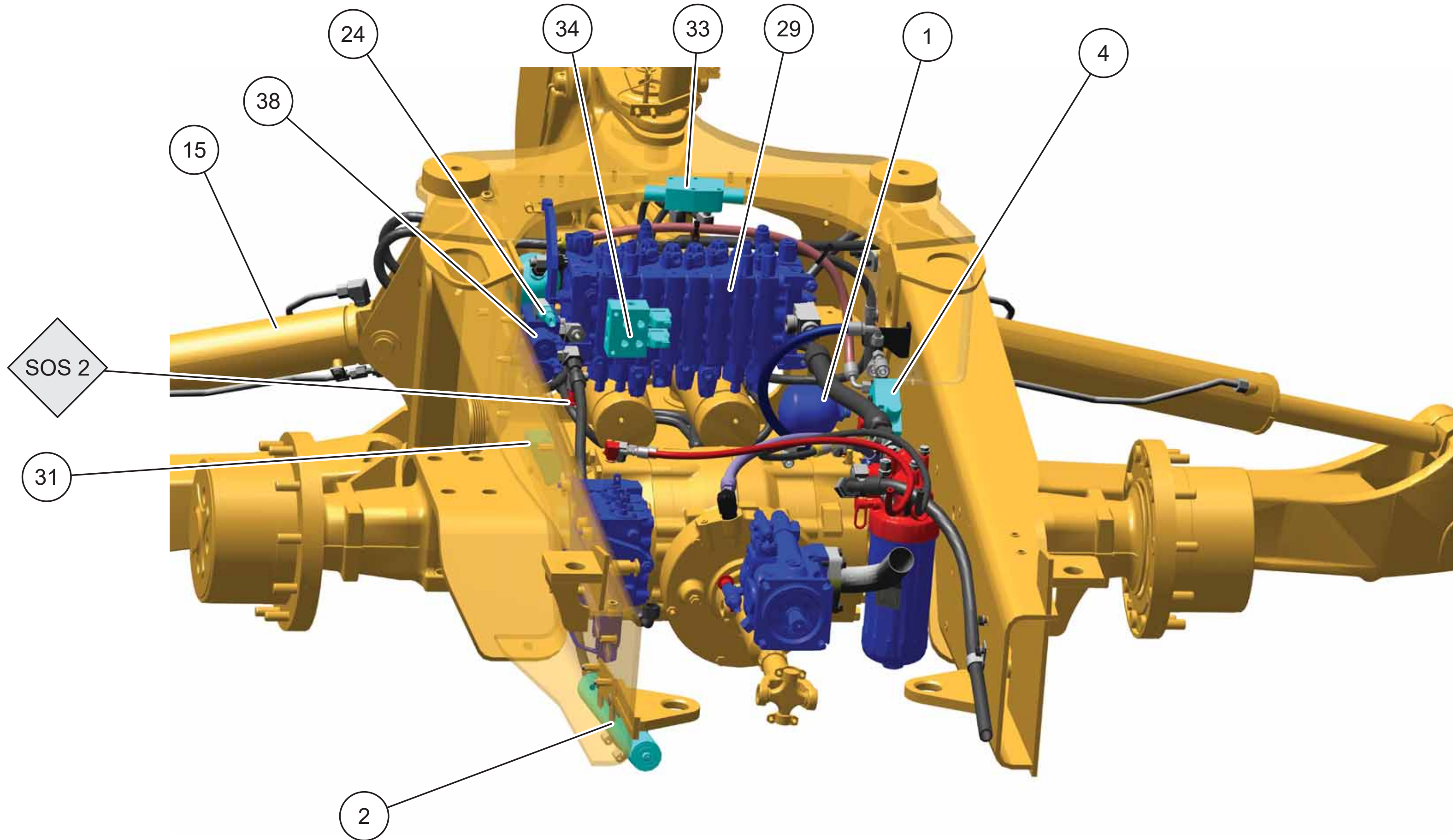

MAIN CONTROL VIEW

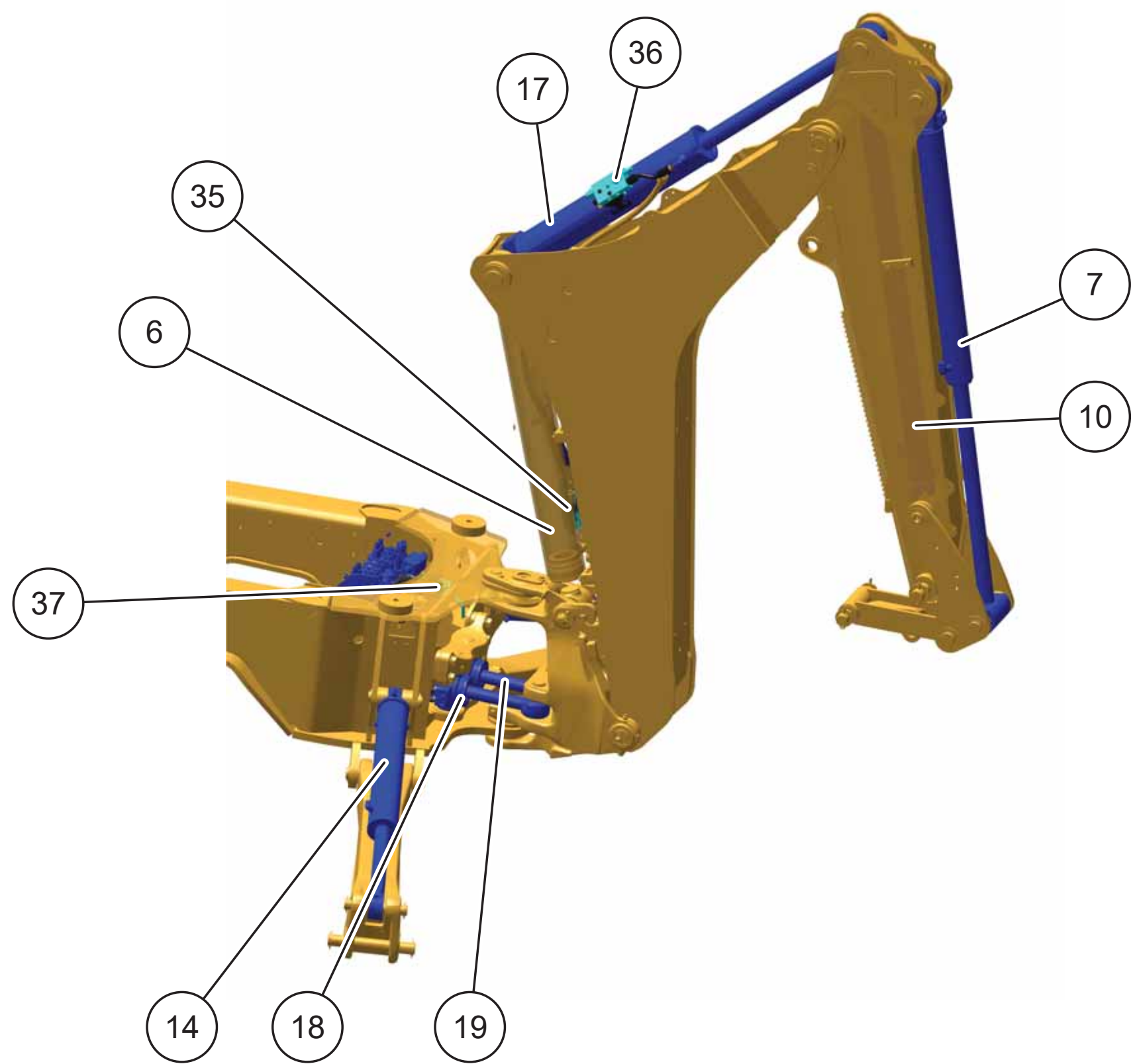

BACKHOE ARRANGEMENT

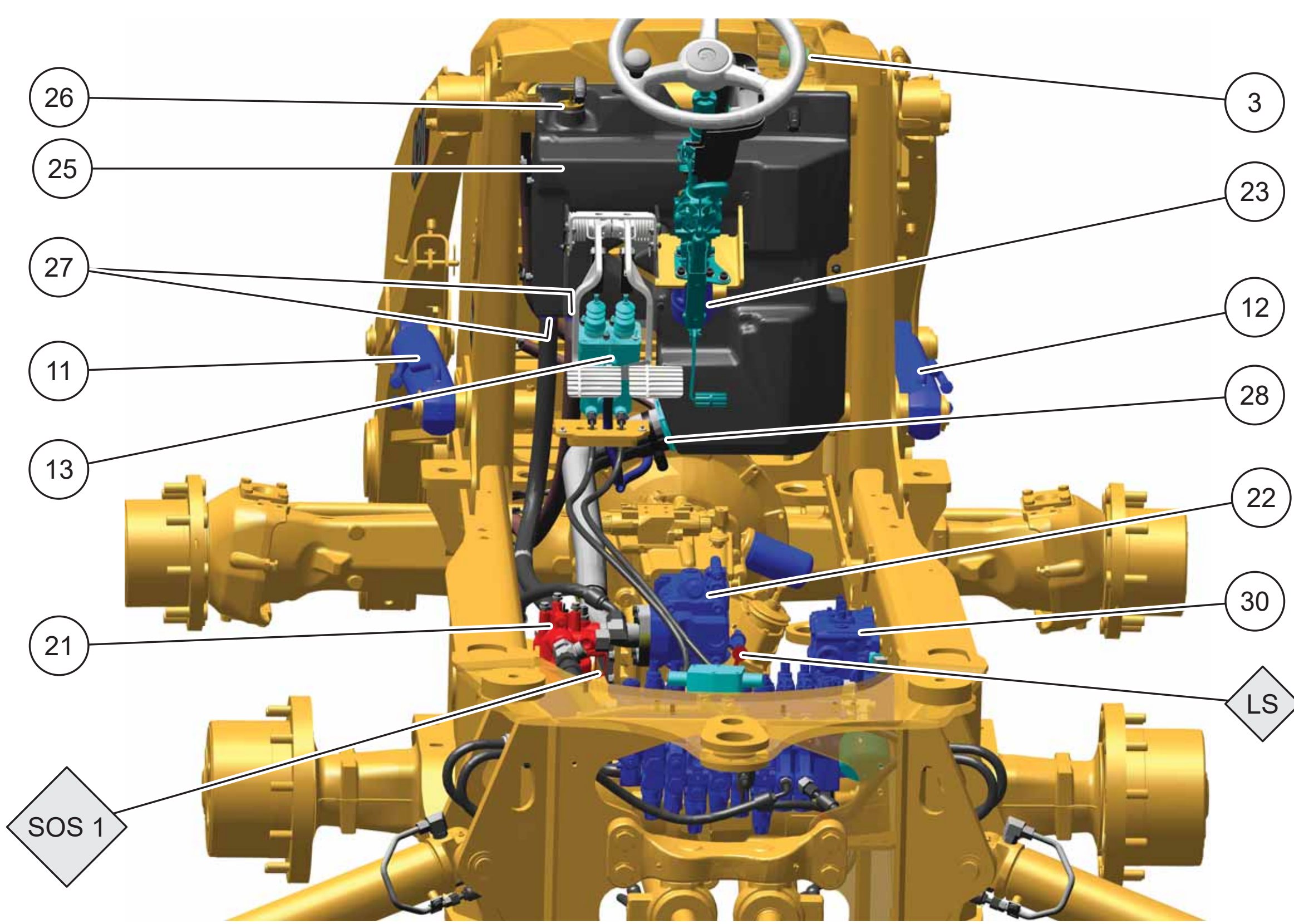

CHASSIS VIEW

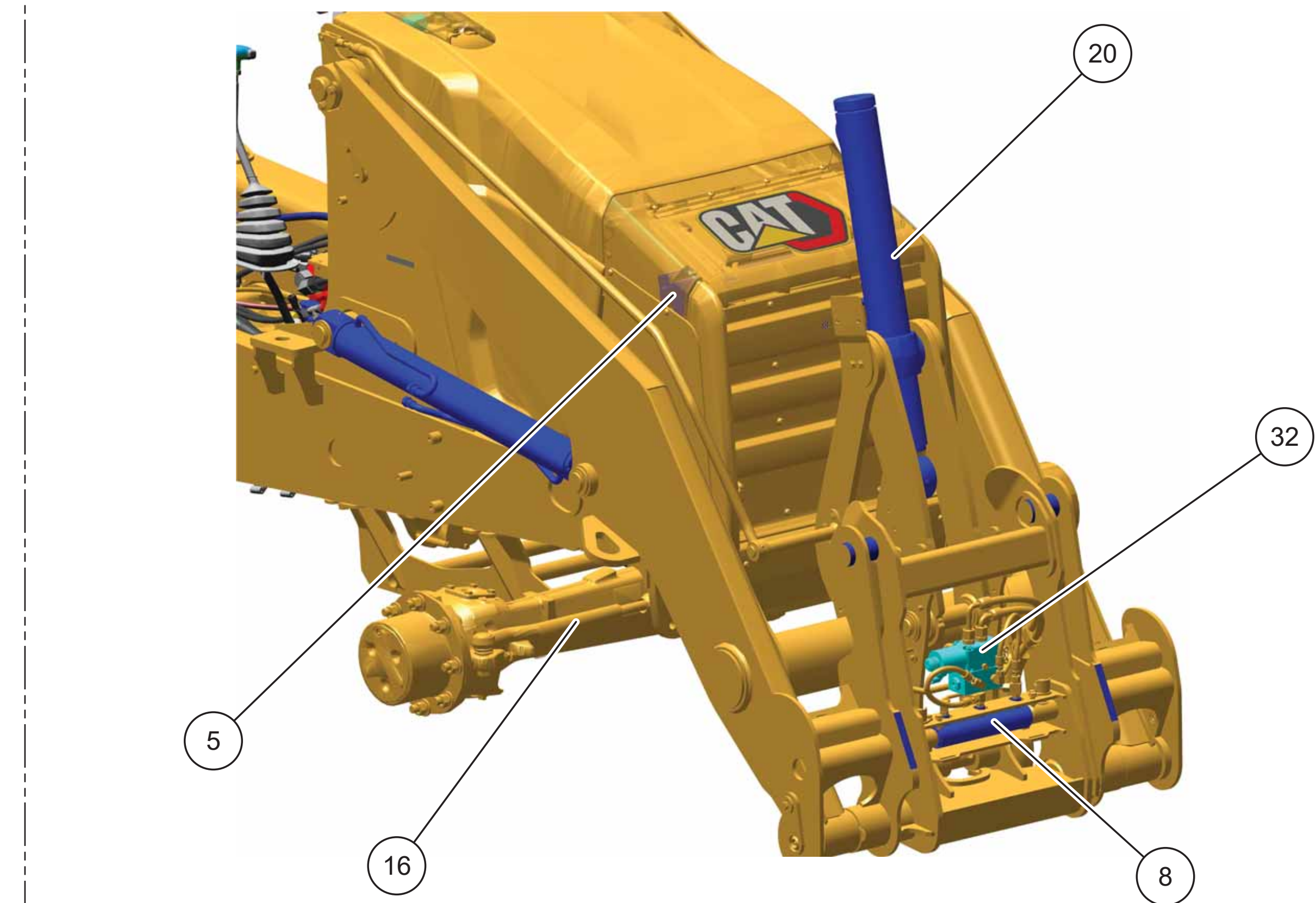

COUPLER VIEW

Component Locations		
Description	Schematic Location	Machine Location
Accumulator Gp - SAHR / Brake	F-13	1
Accumulator Gp (Ride Control)	D-14	2
Breather	B-7	3
Control Gp - Service Brake	F-9	13
Cooler Gp (Hydraulic)	D-7	5
Cylinder Gp - Boom	J-11	6
Cylinder Gp - Bucket	J-9	7
Cylinder Gp - Coupler	B-16	8
Cylinder Gp - Coupler (HOE)	H-2	9
Cylinder Gp - E-Stick	J-6	10
Cylinder Gp - Lift (Left)	B-14	11
Cylinder Gp - Lift (Right)	C-14	12
Cylinder Gp - Stabilizer (Left)	J-13	14
Cylinder Gp - Stabilizer (Right)	J-14	15
Cylinder Gp - Steering	B-16	16
Cylinder Gp - Stick	J-9	17
Cylinder Gp - Swing (Left)	J-10	18
Cylinder Gp - Swing (Right)	J-11	19
Cylinder Gp - Tilt	B-15	20
Filter Gp (Hydraulic)	D-3	21
Pump Gp - Piston	D-8	22
Pump Gp (HML)	C-16	23
Sensor Gp - Pressure (Ride Control)	D-14	24
Tank & MTG Gp - Hydraulic	A-7	25
Tank Gp - Cap Filler	B-11	26
Tank Gp - Diffuser	A-8	27
Tank Gp - Strainer	A-9	28
Valve Gp - Backhoe	I-16	29
Valve Gp - Bank (Loader)	A-12	30
Valve Gp - Coupler (HOE)	E-2	31
Valve Gp - Coupler (Loader)	A-14	32
Valve Gp - Cushion (Swing Control)	J-10	33
Valve Gp - Flow Control (Pattern Changer)	E-5	34
Valve Gp - Hose Burst Check (Boom)	I-12	35
Valve Gp - Hose Burst Check (Stick Load Control)	J-8	36
Valve Gp - Manual (1 Way / 2 Way)	F-3	37
Valve Gp - Ride Control	D-14	38
Valve Gp - Solenoid Pressure Reducing (SAHR / Powershift Only)	F-14	4

Tap Locations Pressure, Sampling, and Sensor		
Tap Number	Description	Schematic Location
SOS 1	Scheduled Oil Sampling Port (Filter Group)	D-4
SOS 2	Scheduled Oil Sampling Port (Control Valve)	I-15
LS	Load Sense Pressure Port	D-8



M0116295
March 2020

Schematic

420 and 430 Backhoe Loader Hydraulic System

NDX1-UP
LBT1-UP
LBT1-UP
HBT1-UP
LBT1-UP
HBT1-UP

Mechanical / Pilot System

SAFETY.CAT.COM

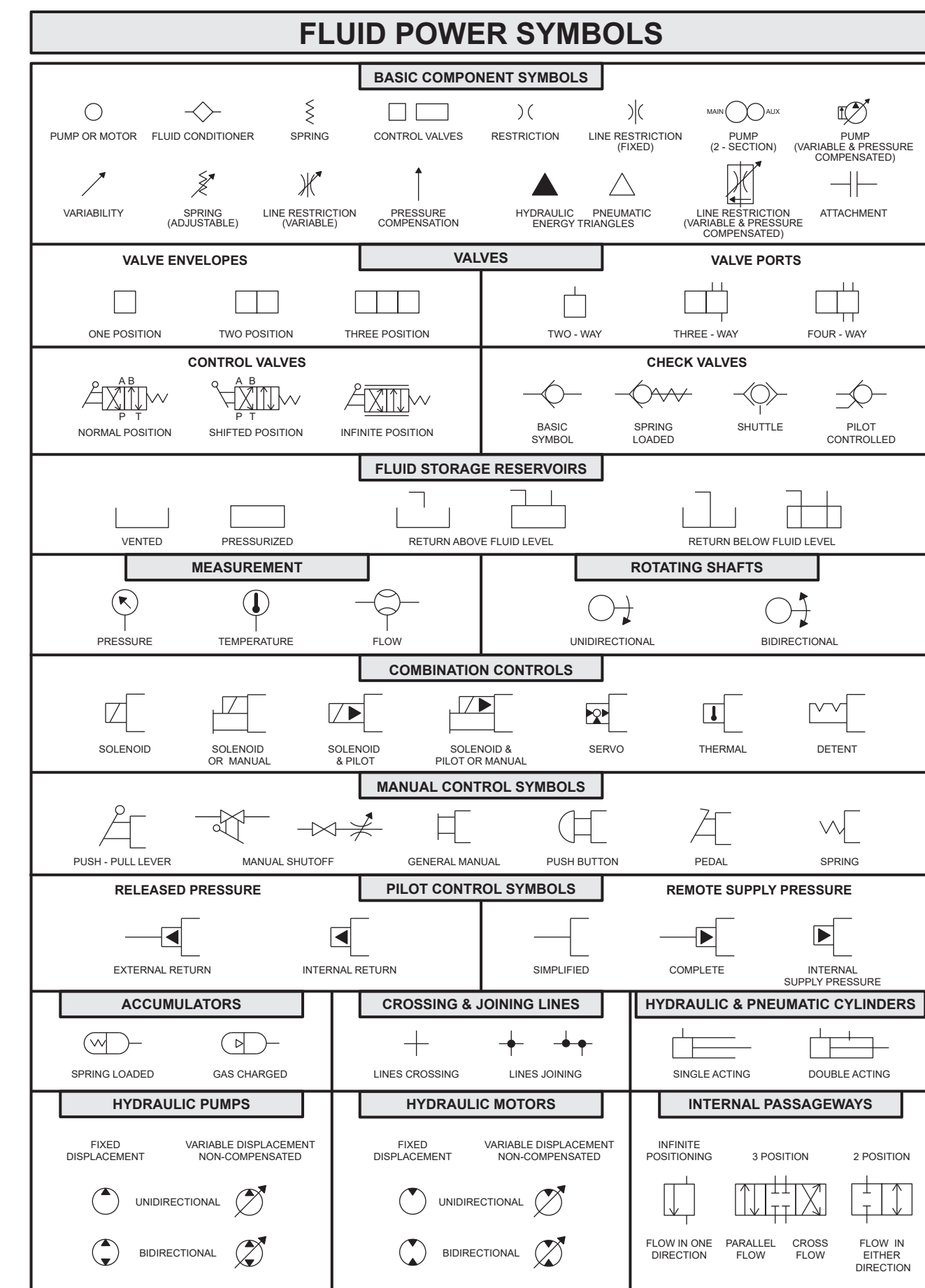

© 2020 Caterpillar. All Rights Reserved. CAT, CATERPILLAR, LET'S DO THE WORK, their respective logos, "Caterpillar Yellow", the "Power Edge" and CAT Model their trade dress, as well as corporate and product identity used herein, are trademarks of Caterpillar and may not be used without permission.

